

Kitchen cabinet prices

(prices shown are for a stain / lacquer finish. For painted finishes add 20%)

1 door base units

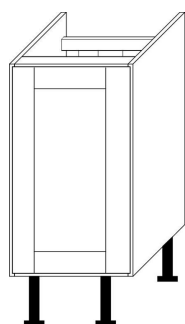

300mm 1 door £169
400mm 1 door £169
500mm 1 door £189
600mm 1 door £189

860mm high x 595mm deep

1 door / 1 drawer base units

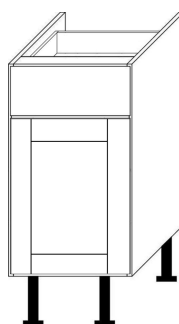

300mm 1 drawer £174
400mm 1 drawer £174
500mm 1 drawer £194
600mm 1 drawer £194

860mm high x 595mm deep

4 drawer base units

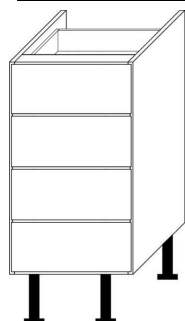

300mm drawer £184
400mm drawer £184
500mm drawer £199
600mm drawer £199

860mm high
x 595mm deep

2 door base units

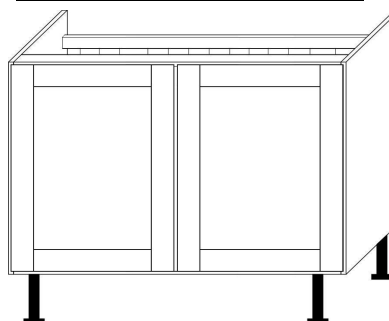

800mm £299
1000mm £319

860mm high
x 595mm deep

2 door base units with drawers

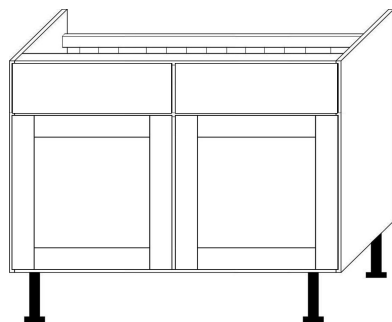

800mm £305
1000mm £329

860mm high
x 595mm deep

Larder units

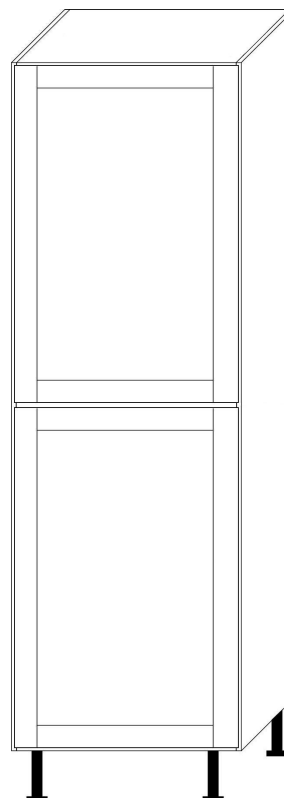

600mm £399

2145mm high
x 595mm deep

Corner return units

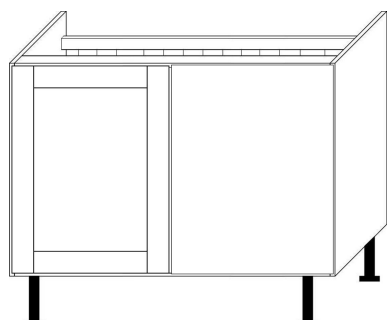

800mm £279
1000mm £299
(Left or right handed)

860mm high
x 595mm deep

All cabinets can be made to bespoke sizes

Belfast base units

600mm £139

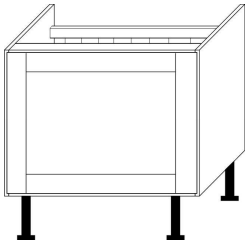

600 mm high
x 595mm deep
(can be altered)

Corner base units

300mm £115

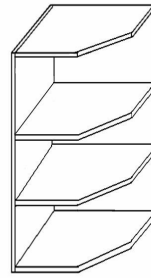

860mm high
x 300mm deep

1 door wall units

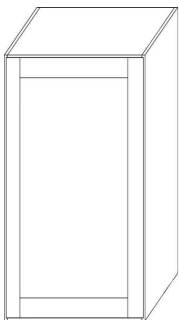

300mm 1 door £149
400mm 1 door £149
500mm 1 door £159
600mm 1 door £159

720mm high x 320mm deep

2 door wall units

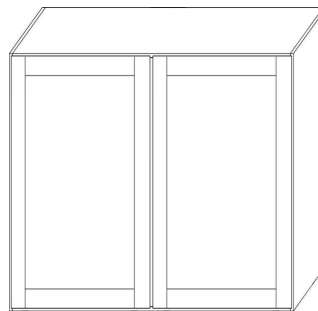

800mm 2 door £239
1000mm 2 door £259

720mm high x 320mm deep

Glazed doors option available on wall cupboards

Corner return wall units

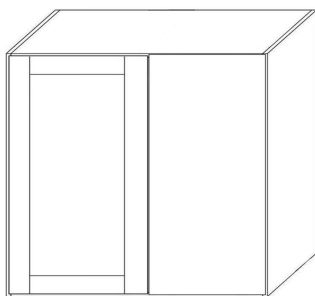

800mm 1 door £219
1000mm 1 door £239
(Left or right handed)

720mm high x 320mm deep

Bridging wall units

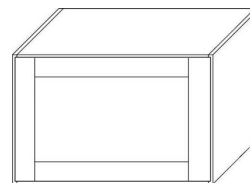

300mm £139

400mm high
x 320mm deep

Corner wall units

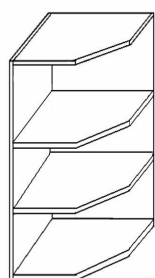

300mm £115

720mm high
x 300mm deep

These prices outline the basic kitchen cabinets available. Because we manufacture we can make cabinets to any size and also copy any design you may have in mind.

All cabinets are available in a stain / lacquer finish and we also offer the option of Farrow & Ball colours in the painted option.

(prices shown are for a stain / lacquer finish. For painted finishes add 20%)



Kitchen shown in a cream paint finish



Kitchen shown in a Farrow & Ball paint finish



Close up design features



Kitchen shown in a chestnut colour wood finish

Door styles



Tongue & groove

Shaker

Fielded



Standard Matt Lacquered Finishes



Unfinished



Clear lacquer



Barley



Chestnut



Antique



Cherry

Standard Paint Finishes

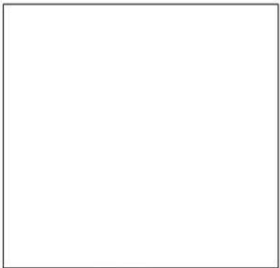

White

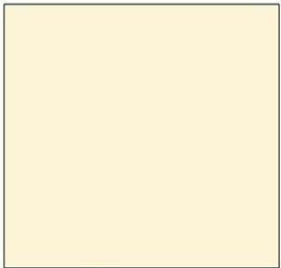

Cream

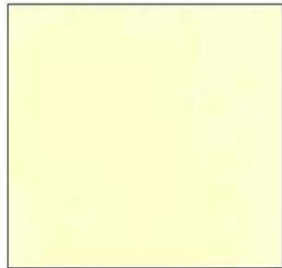

Buttermilk

